



Hosted by
Mid America (NAMASCUSA Affiliate)
& CenMASC (MASCA Affiliate)

SCHEDULE OF EVENTS

*** Events and times are subject to change ***

Wednesday October 14th

8:00am – 7:00pm	Herding Trial 1 Course A Advanced/Open/Started/Junior Dog Herding Trial 2 Course C - Advanced/Open Course B - Started/Junior Dog Herding Capability 1 Herding Capability 2	Location: Herding Field Course Directors: Linda Holloway and Bob Dostie Course Directors: Linda Holloway and Bob Dostie Course Directors: Linda Holloway and Bob Dostie
8:00am - 10:00am	Day of show entries	Location: Secretary's Tent
11:00am – 4:00pm	NAMASCUSA Pre-show Hosted by PACMASC	Location: Next to Herding Field Judge: Sandy Cornwell
Following Herding Trial	Novice/Intermediate Herding Clinic with Linda Holloway	Location: Herding Field
7:00pm – until complete	Barbecue Dinner Round Table Herding Discussion with Linda Holloway	Location: North Tent

Thursday, October 15th

8:00am – 4:00pm	Herding Instinct Tests	Location: Herding Field
8:00am – 5:00pm	APDT Rally Hosted by: An interactive Learning Complex for Your Canine	Location: Between North/South Tents Judges: Yolanda Belluso/Linda Glynn
9:00am – 11:00am	Day of show entries	Location: Secretary's Tent
12:00am – 5:00pm	NAMASCUSA Pre-show Hosted by Mid America	Location: South Tent Judge: Mr. Ronald Steen
5:00pm – 6:00pm	Disc Dog Seminar with Tracy Custer	Location: Main Field
6:00pm – 7:00pm	Grooming Seminar with Cindy Taylor and Karen Keller	Location: Travelodge
7:00pm – 7:30	NAMASCUSA Meeting Wine and Cheese gathering	Location: Travelodge
7:30pm – complete	Dinner Royal Canin Reproductive Seminar	

MINI AUSSIE NATIONALS

Purina Farms-Gray Summit, MO

October 14th-18th, 2009

Friday, October 16th

8:00am – 12:00pm	Disc Dog Trial	Location: Main Show Field Judge: Tracy Custer & John Casey
8:00am – 10:00am	Day of show entries for Nationals	Location: Secretary's Tent
8:00am – 10:00am	NAMASCUSA Puppy Sweeps	Location: South Tent Judge: Mrs. Chris Walkowicz
12:00pm – 5:00pm	NAMASCUSA Nationals Non-Regular Classes Regular Classes and Non-regular puppy NAMASCUSA and MASCA MVA Conformation Judging	Judge: Mrs. Chris Walkowicz Judge: Mr. Brian Meyers Judge: Mr. Brian Meyers
4:00pm – 6:00pm	Rally Seminar with Lisa Bataska	Location: Main Show Field

Saturday, October 17th

8:00am – 4:00pm	CPE Agility Hosted by the Greater St. Louis Agility Club	Location: Agility Field Judge: Lee Ann Zerbian
8:00am-10:00am	Day of show entries (CenMasc)	Location: Secretary's Tent
12:00pm – 4:00pm	MASCA Pre-show Hosted by CenMasc and sponsored by OMASC for the miniature variety of the Australian Shepherd	Judge: Mrs. Cindy Meyers
Following Pre-show	Costume Class Hosted by NEMASC Sponsor Handling Class	Judge: TBA
8:00am – 5:00pm	Canine Good Citizens Test	Location: TBD
7:00pm – 7:30pm	MASCA Membership Meeting	Location: Travelodge
7:30 – Until complete	MASCA/NAMASCUSA Awards Banquet	Location: Travelodge

Sunday, October 18th

8:00am – 5:00pm	CPE Agility Hosted by the Greater St. Louis Agility Club	Location: Agility Field Judge: Lee Ann Zerbian
9:00am-11:00am	Day of show entries (CenMasc)	Location: Secretary's Tent
10:00am – 12:00pm	MASCA Puppy Sweeps	Judge: Ms. Gayle Garvin Location: South Tent
1:00pm- 6:00pm	MASCA Nationals Conformation Show Hosted by CenMasc for the miniature variety of the Australian Shepherd Non-Regular classes Regular classes and Non-regular puppy classes	Location South Tent Judge: Ms. Gayle Garvin Judge: Mr. Paul Thomann

**Conformation shows, Most Versatile Mini Aussie, Herding Trial & Test, Agility, Disc Dog, APDT Rally
CGC Testing, seminars, dinners – something for everyone!!!**

***** Events and times are subject to change *****

Deadline for Pre-Entries is September 23, 2009 for Conformation shows.

Day of show entries accepted each day as noted on the Schedule of Events.

MINI AUSSIE NATIONALS
Purina Farms-Gray Summit, MO
 October 14th-18th, 2009

Table of Contents

Judges and Seminar Hosts: 3
Conformation: 4
Entry Fees:..... 6
Rules and Regulations: 6
General Rules:..... 7
Exhibitors Notice:..... 7
Contact Information:..... 8
Show Location: 9
Map of the Grounds: 10
Hotel Information: 11
Membership Meetings: 11
Additional Information: 11

Judges and Seminar Hosts:

Date	Venue	Judge
Wednesday, 10/14/09	NAMASCUSA Herding Trial	Course Directors: Linda Holloway and Bob Dostie
	NAMASCUSA Pre-Show	Judge: Sandy Cornwell
	Novice/Intermediate Herding Clinic	Linda Holloway
Thursday, 10/15/09	Herding Instinct Tests	Linda Holloway
	APDT Rally	Yolanda Belluso and Linda Glynn
	Disc Dog Seminar	Tracy Custer
	NAMASCUSA Pre-show	Judge: Mr. Ronald Steen
	Grooming Seminar	Cindy Taylor and Karen Keller
Friday, 10/16/09	Disc Dog Trial	Tracy Custer and John Casey
	NAMASCUSA Nationals	
	Puppy Sweeps and Non-Regular Classes	Judge: Mrs. Chris Walkowicz
	Regular Classes, Non-regular puppy classes and MVA Conformation	Judge: Mr. Brian Meyers
	Rally Seminar	Judge: Lisa Bataska
Saturday, 10/17/09	CPE Agility	Judge: Lee Ann Zerbian
	MASCA Pre-Show for the miniature variety of the Australian Shepherd	Judge: Mrs. Cindy Meyers
	Costume Contest/Sponsor Class	Judge: TBD
	Canine Good Citizens Test	Tester: Cheryl Hass
Sunday, 10/18/09	CPE Agility	Judge: Lee Ann Zerbian
	MASCA Nationals for the miniature variety of the Australian Shepherd	
	Puppy Sweeps and Non-Regular Classes	Judge: Ms. Gayle Garvin
	Regular Classes and Non-regular puppy	Judge: Mr. Paul Thomann

MINI AUSSIE NATIONALS
Purina Farms-Gray Summit, MO
 October 14th-18th, 2009

Conformation:

Wednesday, 10/14/09 Conformation Pre-Show	Thursday, 10/15/09 Conformation Pre-Show
Judge: Sandy Cornwell	Judge: Mr. Ronald Steen
Hosted by: PACMASC (NAMASCUSA affiliate)	Hosted by: Mid America (NAMASCUSA affiliate)
Casual dress show – jeans only please!!!	Casual dress show – jeans only please!!!

Classes - Wednesday & Thursday Pre-Shows:

Puppy (2-4, 4-6 Months)	6-9 Months
Junior Handler (5-8, 9-13, 14-18)	9-12 Months
Best Junior Handler/Reserve Best Junior Handler	12-18 Months
Altered 6-12 Months	Bred By Exhibitor
Altered Open	Open
Altered BOB	Winners Dog – Winners Bitch – Best of Winners
Herding Bred (must have a HCC certificate or Herding Title)	Best of Breed/Best Opposite Sex
Classes shall be divided by sex	

Friday 10/16/09 NAMASCUSA Puppy Sweeps & NAMASCUSA Nationals

Judge: Mrs. Chris Walkowicz – Puppy Sweeps & Non-Regular Classes
Judge: Mr. Brian Meyers- Regular Classes, puppy classes and MVA Conformation
Hosted by: Mid America and NAMASCUSA

Classes:

Puppy Sweeps: 2-4, 4-6, 6-9, 9-12, 12-18, Month Puppy - Divided by sex	
Non Regular Classes	Regular Classes
Puppy (2-4, 4-6 Months)	6-9 Months
Junior Handler (5-8, 9-13, 14-18)	9-12 Months
Altered 6-12 Months	12-18 Months
Altered Open	Bred By Exhibitor
Altered BOB	Herding Bred
Veterans (over 7 years)	American Bred
Stud Dog	Foreign Bred
Brood Bitch	Open Black
Brace	Open Blue Merle
Movement	Open Red
Head Type – Male	Open Red Merle
Head Type – Female	Winners Dog/Reserve Winners Dog
Generations	Winners Bitch/Reserve Winners Bitch
Breeders Cup	Best of Winners
	Best Of Breed/Best Opposite Sex
Classes shall be divided by sex	

MINI AUSSIE NATIONALS
Purina Farms-Gray Summit, MO
 October 14th-18th, 2009

Saturday 10/17/09

CenMasc Pre-Show for the miniature variety of the Australian Shepherd

Judge: Mrs. Cindy Meyers
 Hosted by CenMasc and sponsored by OMASC

Classes:

Puppy (2-4, 4-6 Months)	6-9 Months
Best of Breed Puppy/Best of Opposite Sex Puppy	9-12 Months
Junior Handler (5-8, 8-12, 12-18)	Bred By Exhibitor
BIS Junior Handler/Reserve. BIS Junior Handler	Open
Altered Open	Winners Dog/Reserve Winners Dog
Altered Best of Breed/Best of Opposite Sex	Winners Bitch/Reserve Winners Bitch
	Best of Winners
	Best Of Breed/Best Opposite Sex
Classes shall be divided by sex	

COSTUME CLASS AND SPONSORS HANDLING CLASS TO FOLLOW THE CenMasc PRE-SHOW

** Costume Contest Class – Sponsored by NEMASC

Sunday 10/18/09

MASCA Puppy Sweeps & MASCA Nationals for the miniature variety of the Australian Shepherd

Judge: Ms. Gayle Garvin – Puppy Sweeps & Non-Regular Classes
 Judge: Mr. Paul Thomann- Regular Classes and Non-regular puppy classes
 Hosted by: CenMasc & MASCA

Classes:

Puppy Sweeps: 2-4, 4-6, 6-9, 9-12, 12-18, Month Puppy - Divided by sex	
Non-Regular Classes	Regular Classes
Puppy (2-4, 4-6 Months)	6-9 Months
Best of Breed Puppy/Best of Opposite Sex Puppy	9-12 Months
Junior Handler (5-8, 8-12, 12-18)	Bred By Exhibitor
BIS Junior Handler/Reserve. BIS Junior Handle	Open Black
Altered Open	Open Blue Merle
Altered Best of Breed/Best of Opposite Sex	Open Red
Stud Dog	Open Red Merle
Brood Bitch	Winners Dog/Reserve Winners Dog
Veterans (over 7 years)	Winners Bitch/Reserve Winners Bitch
Brace	Best of Winners
Head Type	Best Of Breed/Best Opposite Sex
Movement	
Classes shall be divided by sex	

MINI AUSSIE NATIONALS
Purina Farms-Gray Summit, MO
 October 14th-18th, 2009

Entry Fees:

Entry Fees	Pre-Entry	Day of Show
Puppy (2-4, 4-6, Months)	\$18.00	\$23.00
Veterans (over 7 years)	\$15.00	\$23.00
Non- Regular	\$15.00	\$23.00
Regular	\$20.00	\$25.00
Juniors	\$10.00	\$15.00
Puppy Sweeps	\$18.00	\$23.00
MASCA MVA	\$18.00	\$23.00
NAMASCUSA MVA	\$18.00	\$23.00
Disc Dog - Distance/Accuracy (2 rounds)	\$10.00 donation	\$15.00 donation
Disc Dog – Freestyle (must enter Distance/Accuracy)	\$10.00 donation	\$15.00 donation
APDT Rally	Please see the APDT Rally Premium for entry fees	
CPE Agility	Please see the CPE Agility premium for entry fees.	
Herding Runs (2 per dog)	\$40.00 per run	\$45.00 per run
Herding Instinct Test	\$40.00	\$45.00
CGC Testing		
Rally Seminar	\$30 for team	\$20 to audit
Herding Clinic Novice/Intermediate	\$50 with a limit of 10	\$25 to audit
Disc Dog Seminar	\$25 per team	\$15.00 audit
Grooming Seminar		

See individual venue rules for:

NAMASCUSA Herding program – please see the Herding Program for details.

<http://herdtrial.homestead.com/>

Rally - please see APDT Rally premium for details.

CPE Agility trial - please see CPE agility premium for details.

Disc Dog – Please see the Disc Dog premium for details.

NAMASCUSA/MASCA MVA rules will be posted to the website when approved

Go to <http://www.mamasc.com/Nationals.html> to see all premiums.

Rules and Regulations:

Please be sure you have completed the correct forms for each show/seminar/dinner you are entering!

Show Rules:

MASCA show rules will apply for the MASCA hosted Pre-Show and MASCA National Specialty

They are located in the files section on Mascamembers2@yahoo.com

NAMASCUSA show rules will apply for the NAMASCUSA hosted Pre-shows and National Specialty.

www.Namascusa.com

Premiere awards will be awarded as specified in the show rules of each hosting club.

Puppy Sweeps will be awarded as specified in the show rules of each hosting club.

MINI AUSSIE NATIONALS
Purina Farms-Gray Summit, MO
October 14th-18th, 2009

General Rules:

- Conformation: To be eligible for age group classes, dogs must attain the age of the class on or before the first day of the show and must be entered in the class for its age.
- CPE Agility: Dogs must be 15 months of age or older on or before the first day of the show.
- MVA and Conformation entries in regular classes must be MASCA and/or NAMASCUSA registered OR apply for MASCA and/or NAMASCUSA registration no later than thirty (30) days following the show.
- Pre-registration is recommended; however, we will have registration forms/applications available at the show along with addressed envelopes to the MASCA/NAMASCUSA registrars. The member can fill out the application and give it back to the Show Secretary in a sealed envelope for mailing, but...no one other than MASCA's/NAMASCUSA's registrars can register any dog.
- Please bring a copy of current papers and three-generation pedigree. If dog is not registered within 30 days; forfeiture of winnings, including points, will go to the runner-up dog.
- "A" division dogs MUST be registered through MASCA before showing.
- Standard MASCA & NAMASCUSA show point/major system applies.
- Please use a separate entry form for each dog entered (copying of form permitted).
- All entries must be signed and accompanied by payment (check/ money order/Paypal payable to Mid America or CenMasc).
- **NO REFUNDS, NO SUBSTITUTIONS.**
- **Entries and payment must be RECEIVED by deadline to qualify for pre-entry rates**
- Deadline for Pre-Entries is September 23, 2009 for Conformation shows.
- Day of show entries accepted each day as noted on the Schedule of Events.
- In the event that you have a conflict with a conformation class and a performance class, please inform the ring stewards for both classes so that arrangement can be made.

Mail all entries to:
MAMASC c/o Mindy Stevenson
27560 East 77th Street
Broken Arrow, OK 74014

Email: mshorse@valornet.com
Send me an invoice thru paypal
3% added charge

Exhibitors Notice:

Judging for all classes will commence promptly at scheduled time. Judges will not wait for any dog holding up a class, unless they are entered in a performance event. Please notify the conformation steward of any possible conflicts. Owner or agents alone are responsible for the presence of their dogs in the judging ring when their classes are called for judging. Judges may not judge dogs owned or co-owned by them.

All exhibitors are asked to have their dogs under their complete control at all times. The use of prong collars in the show ring is prohibited. Please be responsible for your dog. Each person is responsible for cleaning up after his or her dog(s). Please, keep our show sites beautiful. For assistance, feel free to call on a Mid America or CenMasc member.

Entry fees will not be refunded in the event that a dog is absent, disqualified, excused by vet or judge, or barred from competition by action of the show chairman or show secretary. If because of riots, civil disturbances, or other acts beyond control of the management, it is impossible to open or to complete the show, no entry fees will be refunded. Postdated checks or returned checks do not constitute a valid entry fee.

MINI AUSSIE NATIONALS

Purina Farms-Gray Summit, MO

October 14th-18th, 2009

Owners are responsible for errors in filling out entry forms. MASCA and/or NAMASCUSA publish show catalogs based on the information provided in the entry forms. Please print clearly. No entry fees will be refunded in the event of such errors or cancellation entries after the published closing date. No entry shall be made and no entry shall be accepted which specifies any condition to its acceptance. MASCA and/or NAMASCUSA reserve the right to change the judges' schedule at any time due to overloading of schedule.

You are not required to have MASCA or NAMASCUSA win sheets signed by judges to acquire MASCA or NAMASCUSA points at the specialty show. Show records will ensure that all points are recorded directly from the judges' books. MASCA or NAMASCUSA championships are recognized with an official MASCA or NAMASCUSA Championship Certificate. Write to MASCA or NAMASCUSA to receive the appropriate championship certificate.

Proof of Championship is required to show in the Best of Breed classes. For Friday BOB, dog must be a NAMASCUSA Champion of record; for Sunday BOB dog must be a MASCA Champion of record.

Contact Information:

CenMasc Board of Directors	Show Committee	Mid America Board of Directors	Show Committee
President: Connie Brogan Vice President: Kathy Agan Secretary: Linda Nichols-Ould Treasurer: Joan Irwin Board member: Dawn Mullins Board member: Jodi Miller Board member: Lynette Poca	Connie Brogan Kathy Agan Dawn Mullins Angela Ogle	President: Traci Phillips Vice President: Kathy Agan Secretary: Heather Glidewell Treasurer: Mindy Stevenson Board member: Jan Sears Board member: Linda Perry Board member: Karen Oldfather	Kim Dostie Traci Phillip Mindy Stevenson Karey Marrs

General Questions Kim Dostie kim@innovativefarms.com 817-798-5213	MASCA Show Secretary Connie Brogan Dtownconnie@aol.com	NAMASCUSA Show Chair/ Show Secretary Traci Phillips traci-phillips@sbcglobal.net
Herding Kim or Bob Dostie kim@innovativefarms.com 817-798-5213 http://herdtrial.homestead.com/ Rules and Courses	Rally www.APDT.com Lisa Bataska Lisa@foryourk9.com	Agility Trial Secretary: Judith Walker studiohillk9@earthlink.net http://www.stlouisagility.org
Disc Dog Angie Ogle minis@wiggiebuttaussies.com 219-465-1624	T-Shirts & Nationals Merchandise Mindy Stevenson mshorse@valornet.com 918-357-3622 www.mamasc.com/nationals.html www.cafepress.com/miniausshep	CGC Cheryl Hass cheryl@chandreafarms.com www.akc.org
NAMASCUSA Liaison Kim Dostie kim@innovativefarms.com 817-798-5213	MASCA Liaison Connie Brogan Dtownconnie@aol.com cell 425-890-6884	MVA NAMASCUSA Tabulation Traci Phillips traci-phillips@sbcglobal.net MVA MASCA Tabulation Mona Cooper Bkcooper@aol.com

MINI AUSSIE NATIONALS

Purina Farms-Gray Summit, MO
October 14th-18th, 2009

Show Location:

All events will be held at:

Purina Farms

200 Checkerboard Dr

Gray Summit, MO 63039-1132

(314) 982-3232

Web site: <http://www.purina.com/purina-farms/>

RV Spaces:

\$50.00 for the week beginning Tuesday 10/13/09 after 12:00pm.

Space with Hook up (power and water) There are no sewage hook ups. Price will include having your rig serviced on Friday. Contact Kim Dostie @ kim@innovativefarms.com to reserve your spot.

Directions:

<http://www.purina.com/purina-farms/policies-maps-directions/index.aspx>

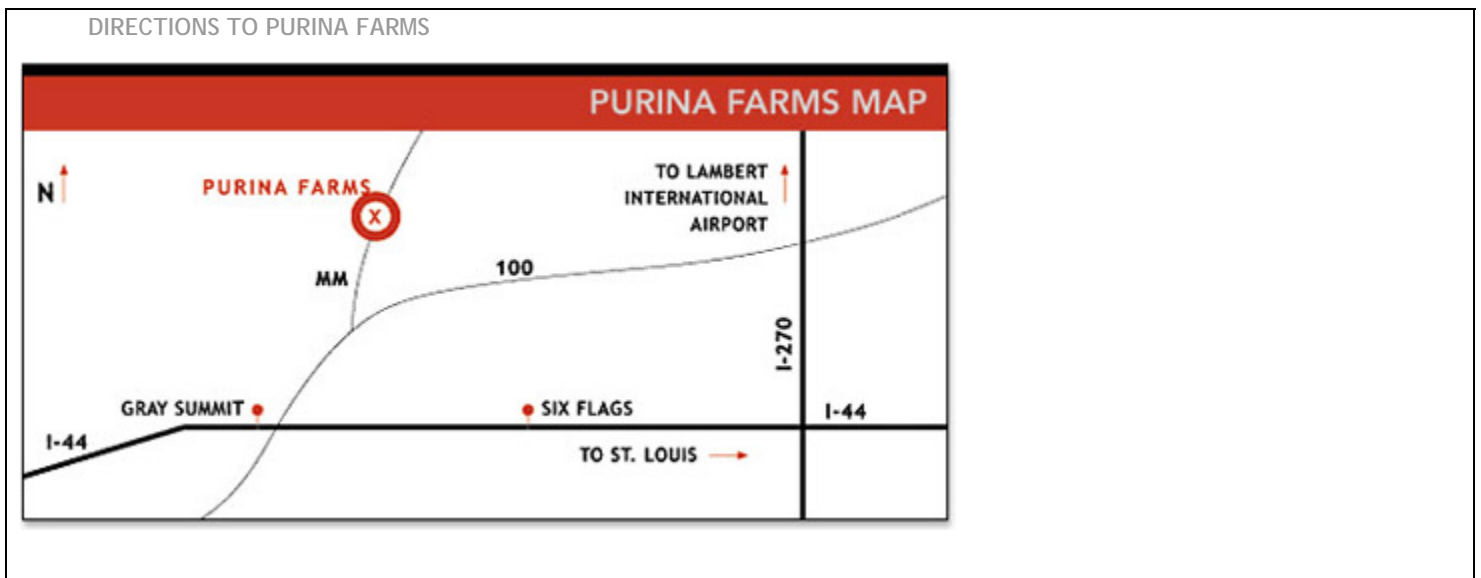

From the St. Louis Airport:

Travel on I-70 west; take exit 232 to I-270 South toward Memphis. Take Exit 5B to I-44 West toward Tulsa. Take the exit 253 Gray Summit and turn right on Highway 100. Travel ½ mile to County Road MM. Turn left on Highway MM for 1 mile to entry gate on left. Look for Purina® Incredible Dog Challenge® signs.

From Downtown St. Louis

Take I-44 West to Exit 253 -Gray Summit and turn right on Highway 100. Travel almost a ½ mile to County Road MM. Turn left on Hwy MM for 1 mile to entry gate on left. Look for Purina® Incredible Dog Challenge® signs.

MINI AUSSIE NATIONALS
Purina Farms-Gray Summit, MO
October 14th-18th, 2009

Map of the Grounds:

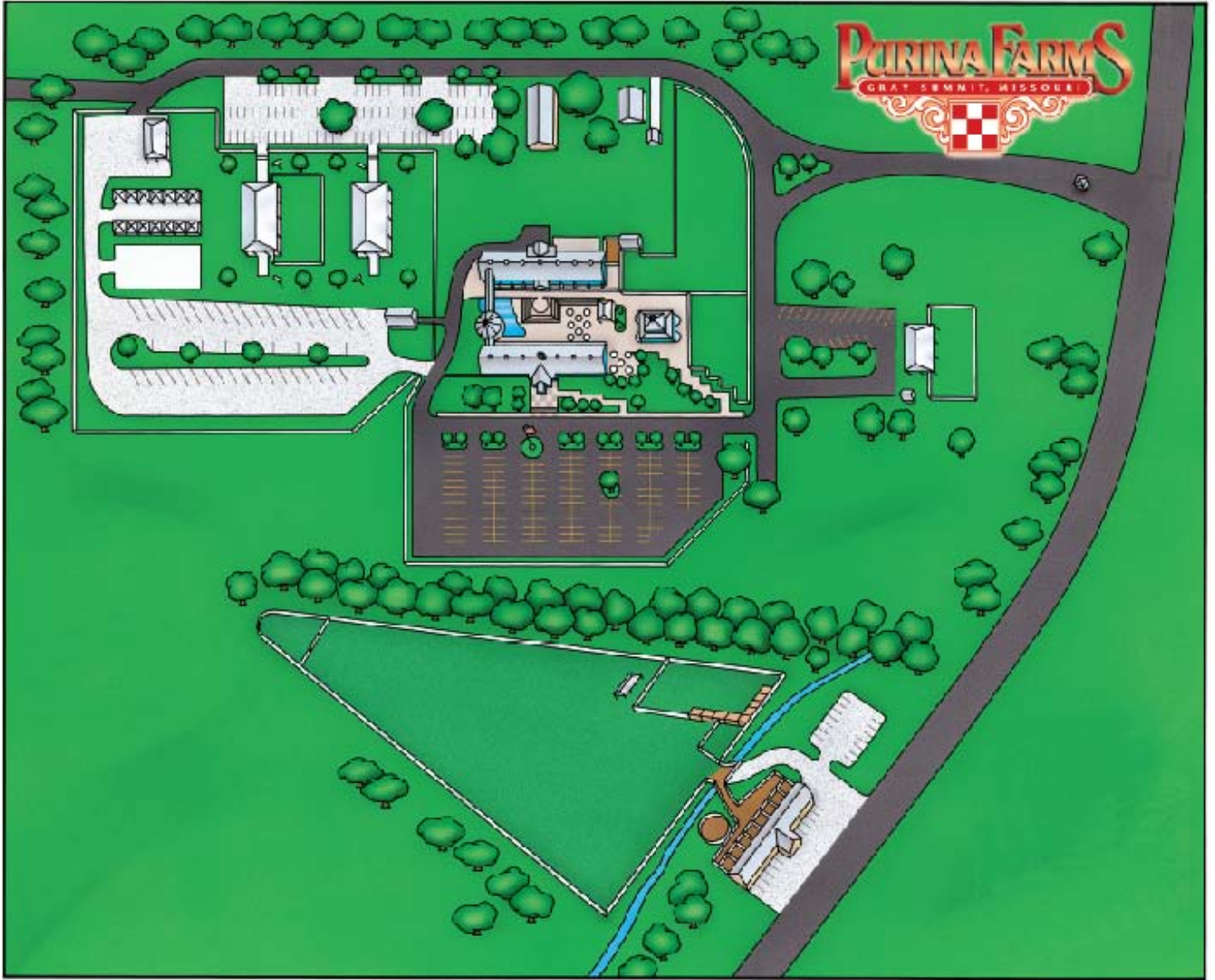

Hospitality:
TBD

MINI AUSSIE NATIONALS

Purina Farms-Gray Summit, MO

October 14th-18th, 2009

Hotel Information:

HOST HOTEL Travelodge Diamond Inn Interstate 44 & Highway 100 Gray Summit, MO 63039 1-800-782-8487 636-742-3501 Pets accepted Pool, game room, mini-golf 1 ½ mile from Purina Farms	Holiday Inn at Six Flags 4901 Six Flags Road Eureka, MO 63025 1-800-782-8108 636-938-6661 Pets Accepted (\$20 fee) Indoor pool, fun-dome, restaurants 10 miles east of Purina Farms	Days Inn Near Six Flags 15 Hilltop Village Center Dr. Eureka, MO 63025 636-587-7000 (tel) 636-938-5729 (fax) Pets Accepted (\$20 fee) Indoor Pool. Fundome 10 miles east of Purina Farms
EconoLodge 1725 West 5th Street Eureka, MO 63025 1-800-251-1962 636-938-5348 Pets accepted (\$20 deposit) Pool, mini-golf 10 miles east of Purina Farms	Eureka Super 8 1733 West 5th Street Eureka, MO 63025 1-800-800-8000 636-938-4368 Pets accepted (\$10 fee) Pool and game room 10 miles east of Purina Farms	

Dinners:

TBD

Awards Banquet:

(Saturday Night) - Schedule to include presentation of event awards for Rally, Herding, Disc Dog and Agility as well as year end awards for each club. MASCA Awards: MVA, Top Ten, Grand CH's, Versatility, and HOF; NAMSCUSA Awards: MVA, Top Ten, Grand CH's,

Membership Meetings:

MASCA Annual Membership Meeting:

The MASCA annual membership meeting will be held Saturday 10/17/09 from 7:00 – 7:30pm. Location: Travelodge

NAMASCUSA Annual Membership Meeting:

The NAMASCUSA annual membership meeting will be held Thursday 10/15/09 from 7:00 – 7:30pm. Location: Travelodge

Additional Information:

MASCA Premier Awards:

We will be offering Premier awards in addition to our Best of Breed, Best of Opposite, and Best of Winners at Sunday's National show. Number of awards presented will be based on entries to be determined after entries close on Sunday. If we have more than 20 dogs entered in Best of Breed, we will award up to 10 Premier – up to 5 each sex. If there are 19 or fewer dogs entered, we will award up to 6 Premier – up to 3 of each sex. No separate entry form required.

MINI AUSSIE NATIONALS

Purina Farms-Gray Summit, MO

October 14th-18th, 2009

NAMASCUSA Premier Awards:

NAMASCUSA will be offering Premier awards in addition to Best of Breed, Best of Opposite, and Best of Winners at Friday's National show. Number of awards presented will be based on entries to be determined after entries close on Friday. No separate entry form required. Number of awards will be determined for both Male and Female entered individually.

- 1 Premier Male (or Female) if less than 5 Specials dogs/bitches entered
- 2 Premier Male (or Female) if 5-7 Specials dogs/bitches entered
- 3 Premier Male (or Female) if 8-10 Specials dog/bitches entered
- 4 Premier Male (or Female) if 11-14 Specials dogs/bitches entered
- 5 Premier Male (or Female) if 15 or more Specials dogs/bitches entered

Puppy Sweeps:

Puppy Sweeps will take place before judging of the Nationals Show (Regular and Non-Regular Classes).

MASCA:

MASCA Registered Puppies Age 2-18 months are eligible. Puppies under 6 months can use litter registration number, instead of individual registration number.

- A. Best of Breed Puppy (60% of entry fees after 50% taken out for MASCA or affiliate plus ribbon).
- B. Best Opposite Sex Puppy (40% of entry fees after 50% taken out for MASCA or affiliate, plus ribbon).

NAMASCUSA:

NAMASCUSA Registered Puppies Age 2-18 months are eligible. Puppies under 6 months can use litter registration number, instead of individual registration number.

25% of total entries shall be withheld for NAMASCUSA or host club to cover expenses. The remaining 75% of total entries will be divided as follows:

- A. Best of Breed Puppy: 60% of monies after distribution to NAMASCUSA or affiliate club.
- B. Best Opposite Sex Puppy: 40% % of monies after distribution to NAMASCUSA or affiliate club.

MASCA Most Versatile Aussie Award – Cecelia Hoffman MVA:

MASCA will be offering its MVA Award. **Deadline for pre-registration is Sept 23, 2009.**

This requires an additional entry fee. Your dog must be MASCA registered to enter.

In order to participate in agility, your dog must be registered with CPE - www.k9cpe.com.

In order to participate in APDT Rally your dog must be registered with APDT - <http://www.apdt.com/po/rally/default.aspx>

MASCA Board will post the MVA rules once they are finalized.

NAMASCUSA "Joseph Hartnagle" Most Versatile Aussie Award:

NAMASCUSA will be offering an MVA award. **Deadline for pre-registration is Sept 23, 2009.**

This requires an additional entry fee. Your dog must be NAMASCUSA registered to enter.

In order to participate in agility, your dog must be registered with CPE - www.k9cpe.com.

In order to participate in APDT Rally your dog must be registered with APDT- <http://www.apdt.com/po/rally/default.aspx>.

Scores will be based on Herding Trial/ Herding Instinct, MVA conformation evaluation, Agility, Rally, and Disc Dog.

NAMASCUSA Board will post the MVA rules once they are finalized.

Mini Aussie Nationals Herding Trial & Test:

Judge: Linda Holloway

There will be a Novice/ Intermediate Herding Clinics with Linda Holloway on Wednesday. There are 10 working spots for the clinic for \$50.00 each. You may audit the clinic for \$25. We will be offering MASCA and/or NAMASCUSA Herding Instinct testing at the show site. You do not have to be MASCA or NAMASCUSA registered. Pre-entry is encouraged, as there are limited spaces. MASCA & NAMASCUSA HIC's are \$40/\$45 per handler/dog. The NAMASCUSA herding test will include HIC and HCC. The NAMASCUSA Herding Trial will include JHD, HSD, HOD, and HAD at \$40/\$45 per run on sheep. 2 runs total per dog, 1 on A Course and 1 on B Course for JHD and HSD.HOD and HAD will run on A and C courses. We will be offering high in level awards and a high in trial award High in Trial MASCA/NAMASCUSA Aussie and HIT Other. Please see the Herding Premium for further details.

MINI AUSSIE NATIONALS
Purina Farms-Gray Summit, MO
October 14th-18th, 2009

Mini Aussie Nationals Agility:

Judge: Lee Ann Zerbian

We will be offering high in level awards and a high in trial award (High in Trial MASCA/NAMASCUSA Aussie). Copy of rules for scoring of HIT and HIL's available upon request. Please see the CPE Agility Premium for further details.

Mini Aussie Nationals Rally:

Judges: Yolanda Belluso and Linda Glynn

We will be offering high in level awards and a high in trial award (High in Trial MASCA/NAMASCUSA Aussie). Please see the APDT Rally Premium for further details.

Mini Aussie Disc Dog Nationals:

This Skyhoundz Local is part of the 2009 Miniature Australian Shepherd Nationals, although all breeds are welcome to participate in the Skyhoundz Local at Purina Farms. Events include Distance/Accuracy & Overall (Freestyle plus highest round of Distance/Accuracy). Players will not be divided into Novice, Open, and Pro, but will be combined into one class Awards. You must enter Distance/Accuracy to be eligible for Skyhoundz Overall !

Distance/Accuracy – There will be 2 rounds of Distance/Accuracy. 1st-3rd place will be awarded for highest combined Toss and Fetch scores.

Overall – The highest round of Distance/Accuracy will be added to the doubled Freestyle round score. (To calculate the Overall total, the Freestyle score will be multiplied by 2 and added to the highest Distance/Accuracy score). 1st-3rd place will be awarded for highest Overall scores.

Special Awards

Best "Toss and Fetch" and Best "Freestyle". Dog must be registered with MASCA and/or NAMASCUSA to be considered for Special awards. Certificates will be awarded for top 4 placements (mini Aussies) for "Toss and Fetch" and "Freestyle".

Note: Only the "Freestyle" portion of "Overall" will be used in the calculation for "Best Freestyle"

For Skyhoundz rules: www.skyhoundz.com

For additional information, contact Angela Ogle at minis@wiggiebuttaussies.com

Entry Donation:

Pre-Entry Distance/Accuracy (2 rounds) \$10.00 Pre-entry or \$15.00 Day of show

Freestyle Overall (1 round – must also enter D/A) \$10.00 Pre-entry or \$15.00 Day of show

Note: Skyhoundz locals do not allow entry "fees", but we are asking for a donation to cover costs so we can offer disc dog in the future. Disc Dog – Please see www.skyhoundz.com for local event rules.

Photographer:

TBD

Vendors:

Vendors are being coordinated by Karey Marrs. Please contact Karey if you would like to set up a booth or for more information. Email: mockingbirdhillkennel@yahoo.com

T-Shirts & Nationals Merchandise:

Mini Nationals 2009 T-shirts will be available to pre-order and a limited amount will be available on the conformation show site. <http://www.cafepress.com/miniaussishep>

Contact Mindy Stevenson at mshorse@valornet.com for more information.

Canine Good Citizen Testing (CGC):

Cheryl Hass cheryl@chandreafarms.com

Canine Costume Class:

NEMASC will be sponsoring a Canine Costume class. Prizes and Ribbons will be awarded for the Most Original Costume, Most Outrageous Costume, and Best Pairs (of dogs) or Handler and dog. For more information please contact Sharon Gilbert at sgilbert@midcoast.com